

Pomeas TC Standard Telecentric Lens Series

PMS-2ST40

1. Support 0.8 MP CCD camera or below
2. Low distortion, high telecentricity and deep depth of field, more suitable for high precision positioning and measuring
3. Telecentric design
4. Support 1/2" CCD
5. Standard C-Mount



Max.Sensor Size
1/2"

Magnification
2.0X

Working Distance
40.4mm

Resolution
3 μ m

C-Mount

Code		PMS-2ST40
Magnification		2.0X
Field of View	1/4"	1.6mm×1.2mm
	1/3"	2.4mm×1.8mm
	1/2.5"	2.9mm×2.2mm
	1/2.3"	3.1mm×2.3mm
	1/2"	3.2mm×2.4mm
Working Distance		40.4mm
Resolution		3 μ m
F.No.		10
TV Distortion		0.04%
Depth of Field		0.2mm
N.A.		0.1
Max.Sensor Size		1/2"
Mount		C-Mount
Illumination		--
Working Temperature		-10°C ~ +50°C

C-mount

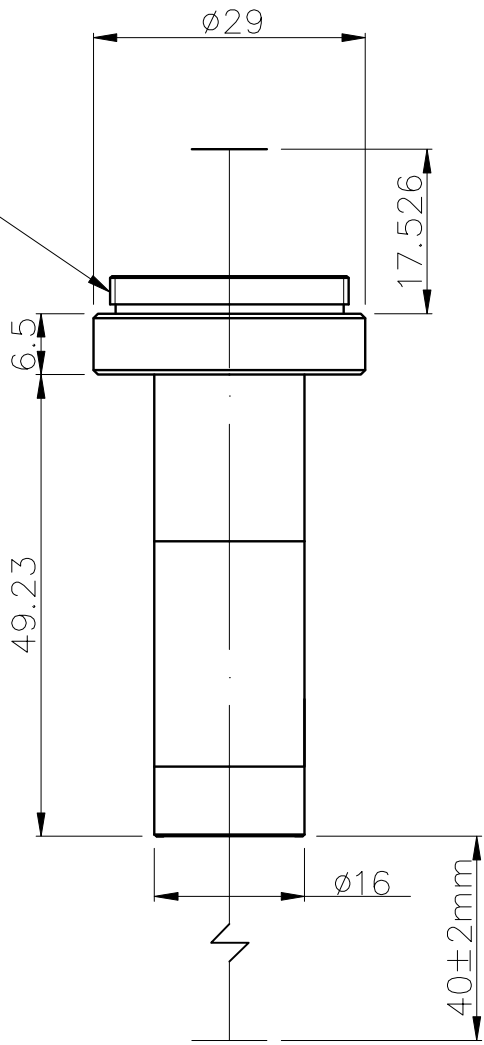

Unit:mm	Scale	1:1
	Name	PMS-2ST40
inch 1.0	Date	2012.7.20
mm 25.0	POMEAS	