

Pomeas Macro Lens Series

PMS-04ML150

1. Support 3MP camera or below
2. High resolution super low distortion even illumination image.
3. Support 2/3" Sensor
4. Standard C-Mount



Max.Sensor Size
2/3"

Magnification
0.4X

Working Distance
148mm

Resolution
10.17 μ m

C-Mount

Code		PMS-04ML150
Magnification		0.4X
Field of View	1/4"	8.0mm×6.0mm
	1/3"	12.0mm×9.0mm
	1/2.5"	14.4mm×10.8mm
	1/2.3"	15.4mm×11.6mm
	1/2"	16.0mm×12.0mm
	1/1.8"	17.9mm×13.4mm
	2/3"	22.0mm×16.5mm
Working Distance		148mm
Resolution		10.17 μ m
F.No.		6.2
TV Distortion		0.02%
Depth of Field*1		3.03mm
N.A.		0.033
Max.Sensor Size		2/3"
Mount		C-Mount
Illumination		--
Working Temperature		-10°C ~ +50°C

*1: Theoretical calculating value(based on diameter of defocused spots is 0.04mm),in the reality application, take its 1/2 will gain the best effect.

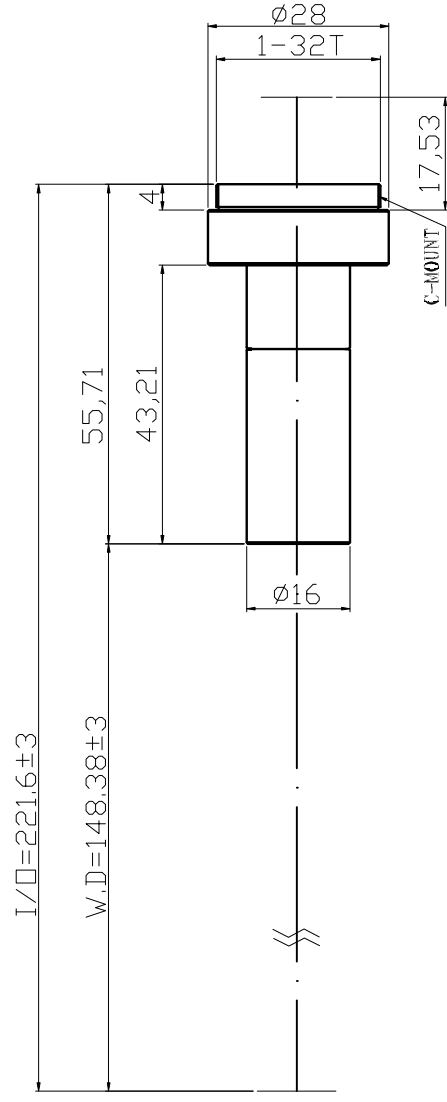

Unit:mm	Scale	1:1
	Name	PMS-04ML150
0.0 inch 1.0	Date	2013.10.30
0.0 mm 25.0	POMEAS	