

**1/3"**

Max. Sensor Size

**MANUAL**

Manual Iris

**CS**

CS

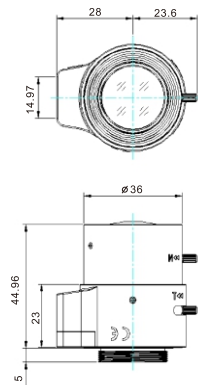

Unit: mm

1. Aspheric surface technology ensure the high quality image.
2. Big Iris F1.0, suitable for dark invisible light environment.
3. The super multi-layer coating reduces flare and ghosting.
4. Professional precision machining offers high quality lens.

<b>Code</b>	PMS-3080SD	
<b>Focal Length</b>	3mm-8mm	
<b>Iris Range</b>	F1.0	
<b>Max. Sensor Size</b>	1/3"	
<b>Field of View (D x H x V)</b>	1/3"	W:125°x96°x70° T:43.2°x34°x26°
	1/4"	W:90.4°x70°x52° T:32.4°x26°x19°
<b>Focusing Range</b>	0.3mm-∞	
<b>Control</b>	<b>Zoom</b>	Manual
	<b>Focus</b>	Manual
	<b>Iris</b>	DC Automatic
<b>Effective Aperture</b>	<b>Front</b>	20.4mm
	<b>Back</b>	10.8mm
<b>Back Focal Length(in air)</b>	W:7.83mm T:13.90mm	
<b>Mount</b>	CS	
<b>Working Temperature</b>	-10°C~+50°C	
<b>Weight</b>	55g	